

INSTRUCTIONS FOR CAPRI TRACK

Part No. 715598101

CP170

IMPORTANT SAFETY INSTRUCTIONS

These Track accessories are for use only with Capri Lighting's "CT" series track system. Care must be taken to see that Capri Track and all connections have been installed in accordance with their instruction sheets, and that the electrical system has been tested before installing fixtures.

DESCRIPTION: Convenience outlet for lighting fixtures on Capri one and two circuit track and intended for operation on either circuit of the track.

Assembly

Important: Care must be taken to see that Capri Track and all connectors have been installed in accordance with their instruction sheets, and that the electrical system has been tested before installing fixtures.

1. Capri Track has a circuit indicator groove on one side of the bottom edge. The groove indicates which of two circuits might energize fixtures installed to the track. Each Fixture Adapter has an embossed line on the underside to indicate which track circuit energizes it.
2. Before inserting fixture adapter, observe the appropriate groove on smooth side for the circuit selected, so that when the adapter is rotated 90° clockwise, indicator line aligns with the groove or smooth side selected.
3. Depress spring-loaded slide lock of adapter. Insert insulated contact at top of adapter fully into track, and push upward as far as adapter will go.
Note: Adapter must be inserted all the way so that both electrical contacts will be made and the diecast cams will engage v-grooves in the track.
4. Keeping the outer housing depressed, rotate the adapter 90° clockwise to engage contacts and diecast CAMS. Release spring loaded outer housing LOCKING TABS into track.
5. The CP170 CONVENIENCE OUTLET CONNECTOR installs in the same way, and it is intended as an electrical power source only. It may not be used to support pendant fixtures.
6. If it is desired to operate TRACK FIXTURES from the other circuit, remove adapter, rotate 180° so that the installed arrow lines up with opposite CIRCUIT INDICATOR GROOVES and reinstall as noted in steps 1-4 above.

NOTE:

When installing or using Capri Track system, basic safety precautions should always be followed. Read all instructions.

WARNING: RISK OF ELECTRICAL SHOCK OR FIRE:

NEVER

- install track to any vertical surface (e.g. walls, vertical beams, columns, door frames). Fixtures may not remain secure, electrical components may be exposed, and hot fixtures may come in contact with persons or combustibles.

NEVER

- install track in wet or damp locations;
- install any part of the track system less than 5 feet above the floor;
- install any fixture assembly closer than 6 inches from any curtain or similar combustible material; or
- attempt to connect power tools, extension cords, appliances or the like to the track.

ALWAYS

- disconnect electrical power before adding to or changing the configuration of the track.

WARNING: RISK OF FIRE. FAILURE TO TIGHTEN ALL CONNECTIONS ON TRACK POWER SUPPLIES, TRACK CONNECTORS, PENDANT KITS, CANOPIES, AND ANY OTHER ELECTRICAL TRACK COMPONENT MAY RESULT IN EXCESSIVE TEMPERATURE AT THE CONNECTIONS CAUSING SPARKS AND/OR FIRE.

SAVE THESE INSTRUCTIONS

CP170

Convenience outlet
(grounded receptacle)

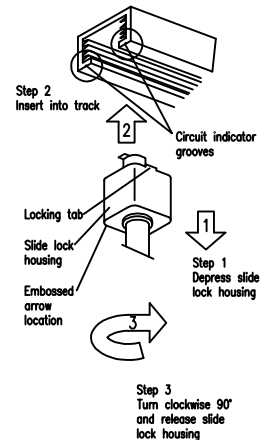
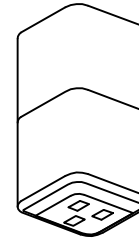

capri
LIGHTING

Capri Lighting
776 South Green Street
Tupelo, MS 38804
662-842-7212
662-841-5501 fax

Canadian Division
189 Bullock Drive
Markham, Ontario L3P 1W4
905-294-9570
905-294-9811 fax