

1' X 4'
1, 2, and 3 Lamp
T8 or T12

UL listed for wet and damp location for covered ceiling use only.

APPLICATION

- Premium quality recessed static troffer for use in:
 - Grid inverted T (NEMA “G”) ceilings.
 - Flange-type ceilings with concealed mechanical suspension (NEMA “F”)
 - Modular and “Z” spline (NEMA “M/Z”) ceilings.

CONSTRUCTION/FINISH

- Die formed ribbed and embossed steel housing.
- Housing is multi-stage phosphate treated for maximum corrosion resistance and finish coat is high reflectance baked white enamel.
- Access plate (2 K.O.'s) factory installed includes grounding screw.
- T Bar grid clips (UL listed, patented) built into fixture end plates, no extra parts required.

ELECTRICAL

- Class P, HPF, CBM certified ballasts comply with Federal Ballast Law (Public Law 100-357, 1988).
- UL listed for wet and damp location for covered ceiling use only. C.S.A. certified optional.

ENCLOSURES

- Flat steel door with mitered corners is standard.
- Extruded aluminum door optional.
- Lens is prismatic acrylic.
- Full perimeter gasketing (closed cell neoprene) between door frame and lens, between housing and door frame where required.
- Guide post spring loaded latches standard.

CATALOG NUMBER

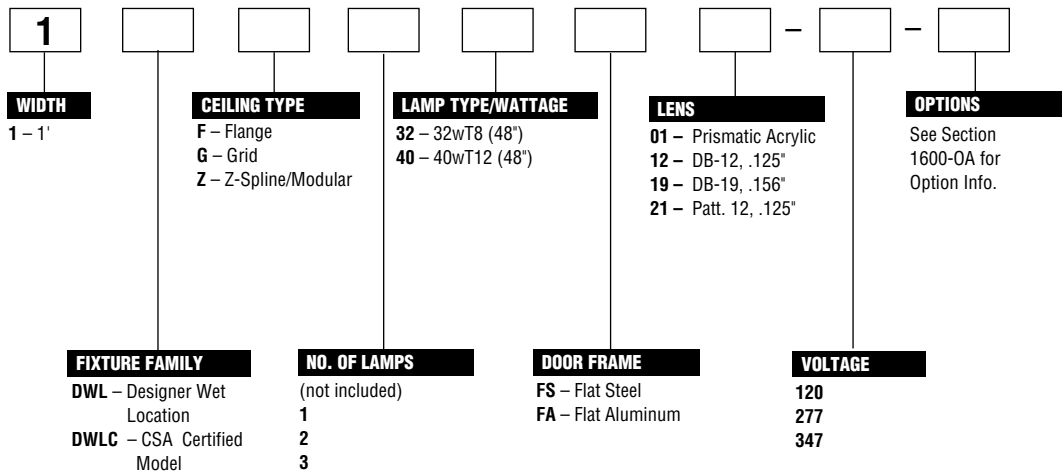

NOTES:

- With generic Electronic Ballasts (Brand selected by Day-Brite)
Suffix Catalog # with – **Ballast Quantity** – / – **-EB Lamps Per Ballast.**

Example: –1/1-EB = One 1 Lamp Electronic Ballast.
Example: –1/2-EB = One 2 Lamp Electronic Ballast.

Example: –1/3-EB = One 3 Lamp Electronic Ballast.

1' x 4' WET LOCATION

DIMENSIONS

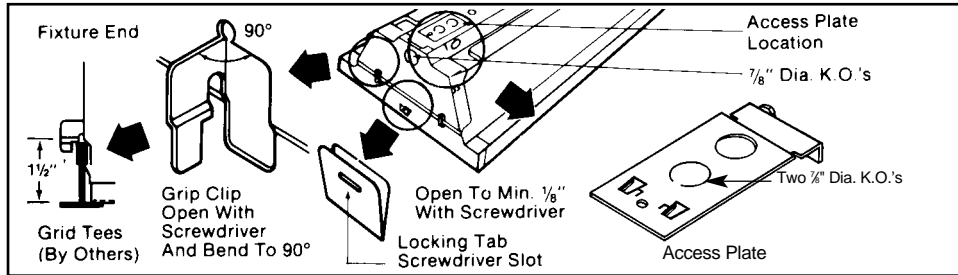
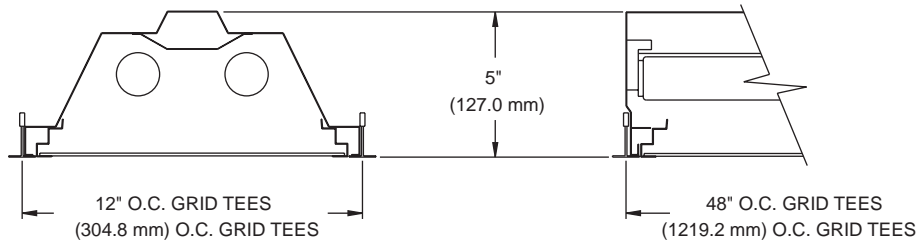

PHOTOMETRIC DATA

CATALOG # 1DWLG232-FS01-1/2-EB LAMPS = F32 T8
 TEST #15184 S/MH=1.2 BALLAST = ELECTRONIC

INPUT WATTS = 59
 BALLAST FACTOR = .92

LER = FL-63

COMPARATIVE YEARLY LIGHTING ENERGY COST PER 1000 LUMENS = \$3.81 BASED ON 3000 HRS. AND \$.08 PER KWH.

FIXTURE EFFICIENCY= 69.8%

CANDLEPOWER			
Angle	End	45	Cross
0	1838	1838	1838
5	1834	1835	1821
10	1811	1811	1796
15	1771	1769	1755
20	1711	1706	1682
25	1635	1616	1569
30	1528	1487	1415
35	1400	1331	1259
40	1243	1149	1109
45	1054	958	935
50	844	764	718
55	638	577	522
60	462	407	378
65	333	277	283
70	241	189	222
75	177	141	180
80	128	110	133
85	67	60	68

MAINTAINED ILLUMINATION TABLE- Square Feet/Fixture*

- 80-50-20 Reflectances (Ceiling-Wall-Floor)
- LLF = 0.76 2900 Lumens/Lamp very clean
- Room width divided by room height = 5 or more, 2 or 1

Fixture Size & # of Lamps	Room Width Room Height =	Approx. Area (sq. ft.) per Fixture			
		10 ft-c	30 ft-c	50 ft-c	70 ft-c
2-Lamp 32WT8	5	-	109	66	47
	2	-	78	47	34
	1	169	57	34	-

*Observe Fixture S/MH Requirements for Specific Applications

AVERAGE LUMINANCE CD/SQ.M WITH 2900 LUMEN LAMPS

ANGLE	END	45°	CROSS
45	5579	5070	4949
55	4162	3764	3406
65	2948	2452	2505
75	2557	2037	2601
85	2868	2569	2911

TYPICAL V.C.P.'s

Room Size	Mounting Height			
	8.5	10	8.5	10
30x30	49	54	49	55
40x40	46	49	45	49
60x30	52	56	52	57
60x60	42	45	42	44
100x100	41	42	41	41

COEFFICIENT OF UTILIZATION

pfc pcc pw	20			70			50		
	70	50	30	70	50	30	50	30	
RCR									
0	83	83	83	81	81	81	77	77	
1	77	74	72	75	73	70	70	68	
2	71	66	62	70	65	61	63	60	
3	66	60	55	64	59	54	57	53	
4	61	54	48	60	53	48	51	47	
5	56	48	43	55	48	42	46	41	
6	52	44	38	51	43	38	42	37	
7	48	40	34	47	39	34	38	33	
8	45	36	30	43	35	30	34	29	
9	41	32	27	40	32	26	31	26	
10	38	29	24	37	29	24	28	23	

LIGHT DISTRIBUTION

DEGREES	LUMENS	% LAMP	% FIXTURE
0-30	1513.	26.1	37.4
0-40	2342.	40.4	57.9
0-60	3554.	61.3	87.8
0-90	4047.	69.8	100.0

LLF = .76 LLF = LIGHT LOSS FACTOR LLF = LDD X LLD X BF LDD = VERY CLEAN 0.94 CLEAN 0.90
 LLD = 0.88 @ 40% RATED LAMP LIFE BF = 0.92 ELECTRONIC BALLAST & T-8 LAMP (RELAMP AT 70% LAMP LIFE)