

**4' OR 8'**  
**2 Lamp**  
**T8**

**APPLICATION**

- Easy to install classroom luminaire.
- Specifically designed around T8 lamps and electronic ballast.
- Can be surface or pendant mounted.
- Can be mounted directly or using the optional sliding hangers.
- Designed for individual or continuous row mounting.

**CONSTRUCTION/FINISH**

- “Herringbone” slots in reflector provide 15% uplight in a smooth, ultra-wide 170° distribution.
- Electrical channel is incorporated into reflector for easier installation.
- 28 cell white louver is attached to reflector with two safety cables for ease of relamping and added safety.
- Louver snaps onto reflector quickly and easily without tools.
- Housing is painted after fabrication with high reflectance white powder coat finish.
- Lamp shielding angles are 40° crosswise and 32° endwise.
- Luminaires supplied less end caps. **Order one set of end caps (cat. #EV-DEK) per individual luminaire or continuous row.**

**ELECTRICAL**

- Class P, HPF ballasts comply with Federal Ballast Law (Public Law 100-357, 1988).
- UL listed for damp locations. Canadian certified optional.
- Self-contained fluorescent emergency power packs can be incorporated (low profile only).
- Energy saving electronic ballasts are standard.

**ACCESORIES**

- **E4-HKK** – sliding hanger bracket with 7/8" hole and retaining bolt.
- **E4-HKS** – sliding hanger bracket with 1/4" x 1" slot and retaining bolt.
- **E4-CHK** – chain hanger kit (pair).
- **EV-DEK** – end caps (pair).

**CATALOG NUMBER**

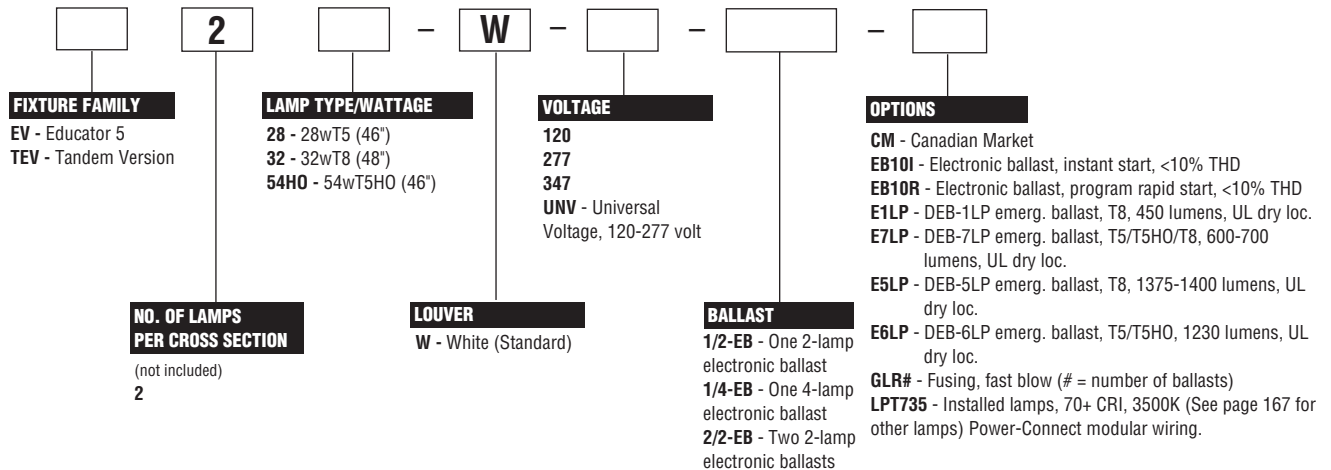

**ACCESSORIES:**

- **E4-HKK**= sliding hanger bracket with 7/8" hole and retaining bolt.
- **E4-HKS**= sliding hanger bracket with 1/4" x 1" slot and retaining bolt.
- **E4-CHK** chain hanger kit (pair).
- **EV-DEK**= end caps (pair).

# 4' OR 8' educator<sup>5</sup>™



## DIMENSIONS

DIM A		DIM B	
4' Fixture	48" (1219mm)	4' Fixture	40" (1016mm)
8' Fixture	96" (2438mm)	8' Fixture	88" (2235mm)

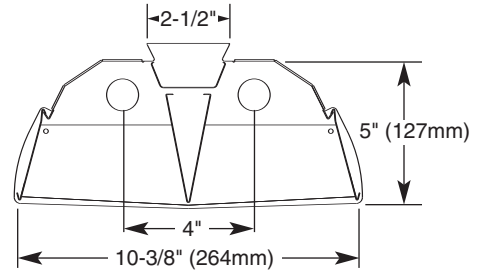
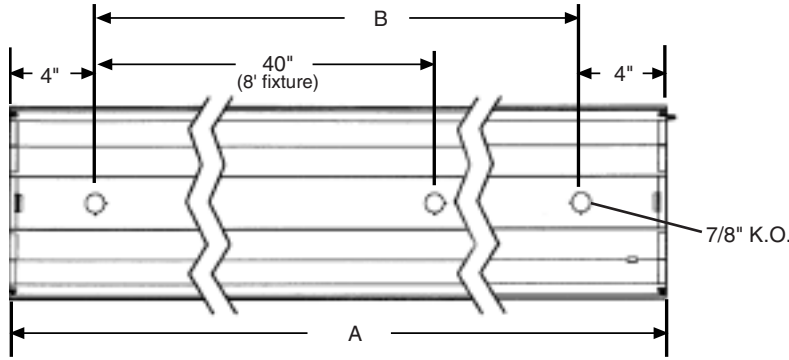

E4-CHK chain hanger bracket

E4-HKK mounting bracket

E4-HKS mounting bracket

7/8" K.O.

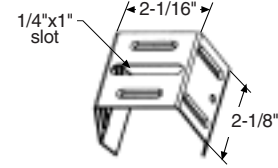
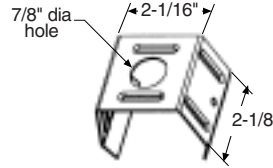
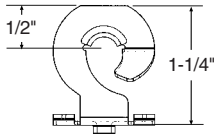

## PHOTOMETRIC DATA

CATALOG # EV232-W-1/2-EB  
TEST #20928 S/MH= 1.1

LAMPS = F32 T8  
BALLAST = ELECTRONIC

INPUT WATTS = 60  
BALLAST FACTOR = .88

LER = 64

COMPARATIVE YEARLY LIGHTING ENERGY COST PER 1000 LUMENS = \$3.75 BASED ON 3000 HRS. AND \$.08 PER KWH.

FIXTURE EFFICIENCY= 76.5%

CANDLEPOWER				
Angle	End	45	Cross	
0	1900	1900	1900	
5	1867	1893	1888	
15	1695	1762	1823	
25	1437	1534	1613	
35	1136	1194	1227	
45	804	813	798	
55	485	479	462	
65	276	267	276	
75	142	143	152	
85	47	70	91	
95	7	52	80	
105	40	58	82	
115	83	80	89	
125	124	109	106	
135	161	144	131	
145	189	172	164	
155	213	197	189	
165	228	220	212	
175	234	233	230	

## MAINTAINED ILLUMINATION TABLE- Square Feet/Fixture\*

- 80-50-20 Reflectances (Ceiling-Wall-Floor)
- LLF = 0.75 2850 Lumens/Lamp very clean
- Room width divided by room height = 5 or more, 2 or 1

Fixture Size & # of Lamps	Room Width Room Height =	Approx. Area (sq. ft.) per Fixture				
		10 ft-c	30 ft-c	50 ft-c	70 ft-c	100 ft-c
4'	5	-	112	67	48	34
2 LAMP	2	-	80	48	34	-
	1	-	60	36	-	-

\*Observe Fixture S/MH Requirements for Specific Applications

## AVERAGE LUMINANCE CD/SQ.M WITH 2850 LUMEN LAMPS

ANGLE	END	45°	CROSS
45	3338	3375	3313
55	2482	2452	2365
65	1917	1855	1917
75	1611	1622	1724
85	1583	2358	3065

## TYPICAL V.C.P.'s

Room Size	Mounting Height			
	Lengthwise	Crosswise	8.5	10
30x30	63	67	61	66
40x40	59	62	56	61
60x60	64	68	64	68
60x60	55	58	49	54
100x100	50	53	40	45

## COEFFICIENT OF UTILIZATION

pfc pcc pw	20	70				50					
		70	50	30	70	50	30	50	30		
RCR											
0	88	88	88	84	84	84	78	78			
1	81	78	75	78	75	72	69	68			
2	75	68	65	71	67	63	61	58			
3	68	61	56	66	59	55	56	52			
4	64	56	50	60	54	47	50	46			
5	58	50	44	56	48	42	46	40			
6	55	46	39	53	44	39	41	36			
7	51	41	35	48	40	34	38	33			
8	47	38	32	46	36	32	34	29			
9	45	34	29	42	34	28	33	28			
10	41	33	27	40	32	27	29	26			

## LIGHT DISTRIBUTION

DEGREES	LUMENS	% LAMP	% FIXTURE
0-30	1375	24.1	31.5
0-40	2115	37.1	48.5
0-60	3168	55.6	72.6
0-90	3670	64.4	84.1
90-180	692	12.1	15.9
0-180	4362	76.5	100.0

LLF = .75 LLF = LIGHT LOSS FACTOR LLF = LDD X LLD X BF LDD = VERY CLEAN 0.94 CLEAN 0.90  
LLD = 0.91 @ 40% RATED LAMP LIFE BF = 0.88 ELECTRONIC BALLAST & T8 LAMP (RELAMP AT 70% LAMP LIFE)

NMLAP The photometric results were obtained in the Day-Brite Lighting Laboratory which is NMLAP accredited by the National Institute of Standards and Technology.