

JOB NAME \_\_\_\_\_  
 TYPE \_\_\_\_\_

# RECESSED 2X2 OPEN REFLECTOR

150-400 watt Metal Halide  
 150-250 watt High Pressure Sodium  
 150-400 watt Pulse Start Metal Halide

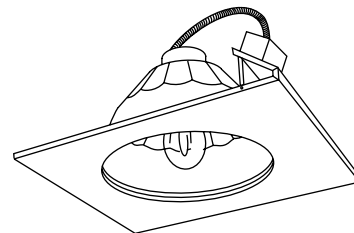

The Recessed Open High Bay fixture is ideal for use in commercial applications such as grocery stores and automobile showrooms.

## ORDERING MATRIX

SAMPLE CATALOG NUMBER: RHC400M12-Q

<b>RHC</b>	□	□	□	-	□
<b>FIXTURE</b> RHC		<b>LAMP SOURCE</b> M - Metal Halide S - High Pressure Sodium P - Pulse Start Metal Halide (Ballast option must also be specified)			<b>OPTIONS (add as suffix)</b> CUL - UL Listed to meet CSA standards LP - Lamp provided in fixture PSC - Pulse Start CWA Ballast WDF - Wired Double Fuse <sup>45</sup> WSF - Wired Single Fuse <sup>46</sup> Q - Quartz Standby <sup>39</sup> QEM - Quartz Emergency <sup>39, 40</sup> QTD - Quartz Time Delay <sup>39</sup> EP-HL - HI/LO Ballast <sup>86</sup> OR - Open Rated Socket EP - Encased & Potted Ballast <sup>89</sup> EC - Wired for Electro-Connect Wiring System <sup>90</sup>
	<b>WATTAGE</b>		<b>VOLTAGE</b>		
	150 - 150 <sup>78</sup> 175 - 175 <sup>4, 78</sup> 200 - 200 <sup>31, 78</sup> 250 - 250 <sup>78</sup> 320 - 320 <sup>30, 78</sup> 350 - 350 <sup>30, 78</sup> 360 - 360 <sup>78, 79</sup> 400 - 400 <sup>4</sup>		12 - 120 20 - 208 24 - 240 27 - 277 34 - 347 3T - 120/347 (250 watt and below)		

**Footnotes:**

- <sup>4</sup>Not available in High Pressure Sodium.
- <sup>30</sup>Pulse Start Metal Halide only.
- <sup>31</sup>Not available in standard Metal Halide.
- <sup>39</sup>Pre-wired by factory.
- <sup>40</sup>Requires 120 volt secondary power supply.
- <sup>45</sup>Use with 208 and 240 volt.
- <sup>46</sup>Use with 120, 277 and 347 volt.
- <sup>56</sup>Must specify voltage.
- <sup>78</sup>Must specify open rated socket ("OR" option).
- <sup>79</sup>360 watt Metal Halide lamp operates on 400 watt M59 ballast.
- <sup>89</sup>Encased & Potted ballast standard for 208 and 240 volt. EP suffix not required for these voltages.
- <sup>90</sup>Consult factory for appropriate Electro-Connect component.

**ACCESSORIES (order separately)**

- FMK-22 - Flange Mounting Kit
- RHC138C - Bottom Enclosure (VDT converter with DB-12 lens installed)

**General Notes:**

Mogul base lamp only.  
 All options are factory installed.  
 All accessories are field installed.

**Warning:** Metal Halide lamps are rated for enclosed fixtures only. Some lamps are specifically rated for open fixtures and require an open rated socket (option code "OR"). Refer to and follow the lamp manufacturer's warnings and instructions.

## DIMENSIONS

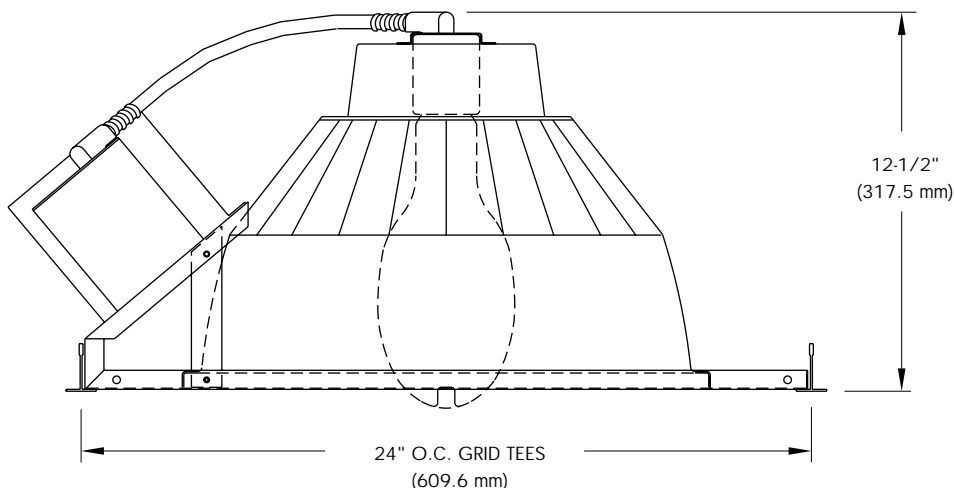

## ENERGY DATA

**HIGH PRESSURE SODIUM**

HX BALLAST INPUT WATTS

150 watt - 188 watts

CWA BALLAST INPUT WATTS

200 watt - 240 watts

250 watt - 295 watts

**METAL HALIDE**

HX BALLAST INPUT WATTS

150 watt - 185 watts

CWA BALLAST INPUT WATTS

150 watt - 189 watts

175 watt - 210 watts

200 watt - 232 watts

250 watt - 295 watts

250 watt - 288 watts

(Pulse Start Metal Halide)

320 watt - 368 watts

350 watt - 400 watts

400 watt - 458 watts

400 watt - 450 watts

(Pulse Start Metal Halide)

PHOTOMETRICS

RECESSED 2'X2' OPEN REFLECTOR 400 WATT MH

WIDE SPREAD S/MH = 2.0

TEST NO. 18740

DISTRIBUTION CURVE	COEFFICIENTS OF UTILIZATION	AVERAGE BRIGHTNESS				ZONAL SUMMARY				CANDLEPOWER												
	EFFECTIVE FLOOR CAVITY REFLECTANCE 20 PER (pfc=0.20)										ZONE	END	45	CROSS	Degrees	Lumens	% Lamp	% Fixture	Angle	Avg. Candela	Angle	Avg. Candela
	CEIL 80 70 50 30 10										45	61685	63020	61981	(0-30)	5841	14.6	18.0	0	5948	50	9299
	WALL 70 50 30 10 70 50 30 10 50 30 10 50 30 10										55	97766	96354	94110	(0-40)	11073	27.7	34.2	5	6398	55	10275
	RCR										65	60468	66141	64872	(0-60)	26488	66.2	81.7	10	6978	60	9022
	0 96 96 96 96 94 94 94 94 90 90 90 86 86 86 83 83 83										75	11915	12992	14795	(0-90)	32417	81.0	100.0	15	6673	65	5030
	1 88 85 81 78 86 83 80 77 80 77 75 76 74 72 73 72 70										85	2461	2461	2400	(90-180)	0	0.0	0.0	20	6298	70	1759
	2 80 73 68 63 78 72 67 62 69 64 61 66 63 59 64 61 58										COMPARATIVE YEARLY LIGHTING ENERGY COST PER 1000 LUMENS = \$3.38 BASED ON 3000 HRS. AND \$.08 PER KWH.				25	7137	75	639				
	3 72 63 56 51 70 62 56 51 60 54 50 57 53 49 55 51 48														30	8263	80	199				
	4 65 55 48 42 63 54 47 42 52 46 41 50 45 40 48 44 40										These photometric results were obtained in the Day-Brite Lighting Laboratory which is NVLAP accredited by the National Institute of Standards and Technology.				35	8408	85	40				
	5 59 48 41 35 58 47 40 35 46 39 34 44 38 34 42 37 33														40	7838						
	6 54 43 35 29 53 42 35 29 40 34 29 39 33 29 38 32 28										45	8205										
7 50 38 30 25 48 37 30 25 36 30 25 35 29 25 34 28 24																						
8 46 34 27 22 45 34 27 22 33 26 22 31 26 21 30 25 21																						
9 43 31 24 19 41 30 24 19 30 23 19 29 23 19 28 23 19																						
10 40 28 21 17 39 28 21 17 27 21 17 26 21 17 25 20 17																						

ADDITIONAL TEST NUMBERS

DESCRIPTION	TEST NUMBER
RHC400P	18131-1P

PRODUCT FEATURES

UL 1598 Listed for damp locations.

- Vertical lamp mounting for greater efficiency.
- CWA HPF encapsulated ballast for quiet operation. Integral thermal protector. Ultra-quiet encased and potted ballast available.
- 3/4" conduit entries in wiring box.
- Precision spun, multi-faceted heavy gauge aluminum reflector.
- Mounting pan has white polyester powder finish.
- High efficiency 2'X2' static luminaire is for use in inverted T-bar ceilings.

Note: Lamp wattages below 360 must specify open rated socket ("OR"), unless enclosed option is specified.

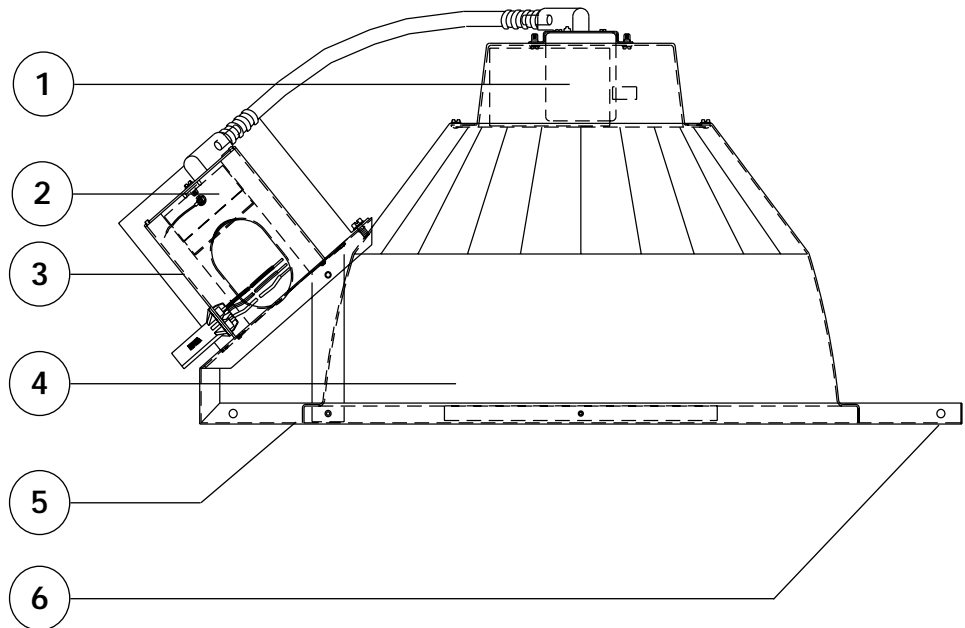

Visit our web site at [www.daybritelighting.com](http://www.daybritelighting.com)

776 South Green Street Tupelo, MS 38804 Phone: 662-842-7212 Fax: 662-841-5501

CI-14030

189 Bullock Drive Markham, Ontario Canada L3P 1W4 Phone: 905-294-9570 Fax: 905-294-8911  
 Day-Brite Lighting reserves the right to make changes without notice. ©September 2001. DL2.5M0301  
 Day-Brite Lighting is a Genlyte Thomas Group.

