

OM82H42PLTFLD/FLR

8" Decorative Trim Downlight

CAT. NO: _____

TYPE: _____ PROJECT: _____

PRODUCT INFORMATION

Applications

A tempered soda lime glass trim features a silkscreened center disk with a solid clear outer ring. The trim is placed in a fixed position with aluminum spacers to eliminate direct lamp image.

Specifications

1. **Ballast** - One (1) Type 1 Class P, high power factor universal voltage electronic compact fluorescent ballast. Offer both 1 or 2 lamp operation for 120 through 277 volt input voltage.

	(2) 18W 120V	18W 277V	(2) 26W 120V	26W 277V	(2) 32W 120V	32W 277V	(2) 42W 120V	42W 277V
Line current amps	.34	.15	.49	.21	.58	.26	.76	.32
Input watts including ballast loss	40	40	56	56	69	67	91	90
Ballast factor	.98+	.98+	.98+	.98+	1.00	1.00	.98	.98
Minimum starting temperature	0°F	0°F	0°F	0°F	0°F	0°F	0°F	0°F

2. **Mounting pan** - Precision die-stamped 16 gauge galvanized steel. Accommodates ceiling materials up to 1-3/8" thick.

3. **Installation** - Mounting pan has pre-installed C-channel with vertical and horizontal adjustments. Ballasts and junction box are accessible from below ceiling. For 27" flat bar hanger pair, specify Q1031 accessory, ordered separately.

4. **Reflector** - Precision spun .050 aluminum one piece reflector, self flanged with clear specular low iridescent Alzak finish. Standard flat flange is polished with matching reflector finish.

5. **Decorative Trim** - Glass: 1/4" thick tempered trim with silkscreened ceramic glaze.

6. **Sockets** - CFM42W/GX24q, CFM32W/GX24q, CFM26W/GX24q, CFM18W/GX24q, CFQ26W/G24q, CFQ18W/G24q.

7. **Junction box** - Extra large 43.75-cubic inch 16 gauge galvanized steel with snap-on cover and ground wire riveted to frame. Approved for through wiring with up to 8 #12 AWG conductors.

8. **Optional emergency system** - Emergency system includes battery, electronic circuitry, charger, and test/monitor plate with test switch and charging indicator light. Test monitor plate may be installed in the ceiling near the fixture or other remote location. Operates appropriate lamp wattage for a minimum of 90 minutes following power failure. Battery is recharged automatically following restoration of power. Emergency system complies with NFPA life safety code, OSHA and NEC. Suitable for dry locations.

9. **U.L. Listed** - For use in damp locations and approved for Through Branch Circuit Wiring. I.B.E.W. union made.

* Canadian Specifications may vary from these shown, consult Canadian Division.

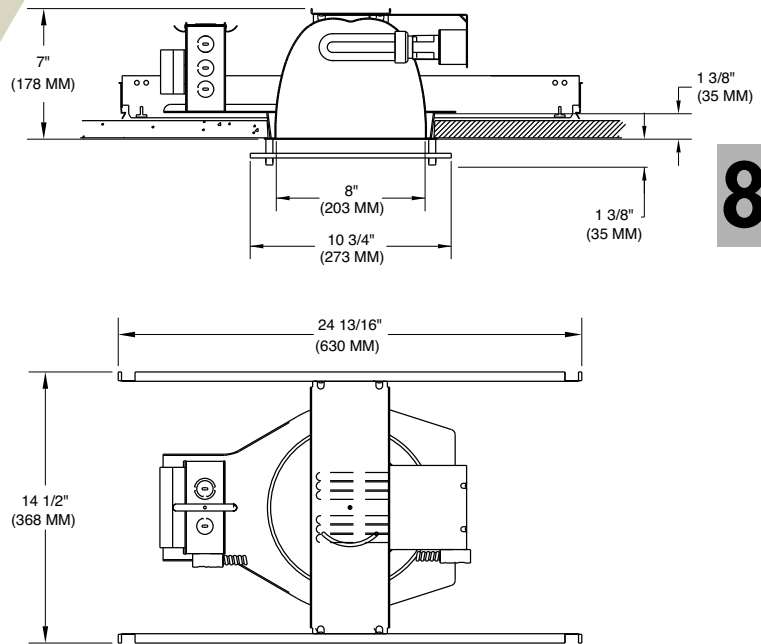
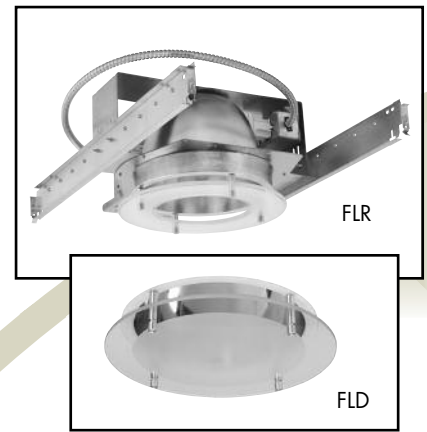

8

CATALOG SYSTEM AND OPTIONS

EXAMPLE OF COMPLETE CATALOG NUMBER: **OM82H42PLTFLD-CSFF-120/277**

OMEGA Apr.	No. of Lamps	Lamps Position	Lamp (by others)	Trim Type (required)	Reflector Finish*	Options	Supply Voltage
OM8	1	Horizontal	42 PLT Triple Tube CFL	FLD Floating	CSFF Clear Specular Finish Flange	EM Emergency	120/277
	2		32 PLT Triple Tube CFL	Luminous Disk	FCSFF Faceted Clear Specular Finish Flange	FZ120 Fusing	347 *
			26 PLT Triple Tube CFL	FLR Floating	FCSSFF Faceted Clear Semi Spec Finish Flange	FZ277 Fusing	
			18 PLT Triple Tube CFL	Luminous Ring	FHZFF Faceted Haze Finish Flange	FZ347 Fusing	
			26 QPL Quad Tube CFL			CP Chicago Plenum	
			18 QPL Quad Tube CFL			Q1031 Flat Bar Hangers	
						SA6 Sloped Ceiling Adpt.	
						DL1 Dimming, Lutron Compact SE, 120v	
						DL2 Dimming, Lutron Compact SE, 277v	
						DX1 Dimming, Advance Mark X, 120v	
						DX2 Dimming, Advance Mark X, 277v	



FIVE YEAR
Warranty

OM82H32PLTFLD-CSFF Photometric Data

Decorative Lens with Floating Luminous Disk

Report Number: 21439
 Lamp: (2) CFM32W
 Total Lumens: 4800
 Fixture Efficiency: = 44.9%
 IES File: F21439.IES
 S/MH Ratio = 1.3, 1.5
 Beam Angle: 103.11

LIGHTING PERFORMANCE DATA		
CEILING HEIGHT* (FT.)	INITIAL FOOTCANDLES	BEAM DIAMETER (FT.-IN.)
8	26.6	13-1
10	14.3	18-11
12	8.9	23-1
14	6.1	28-12
16	4.4	34-0

DISTRIBUTION CURVE

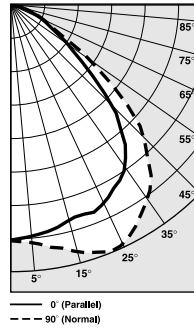

DEGREES	CANDELA		FOOT-LAMBERTS
	AT 0°	AT 90°	
90	13	13	
85	19	21	2065
75	71	74	
65	144	154	3173
55	267	365	4985
45	522	660	7522
35	691	822	
25	755	908	
15	767	870	
5	795	813	
0	804	804	

COEFFICIENTS OF UTILIZATION ZONAL CAVITY METHOD

Effective Floor Cavity Reflectance 0.20

RC	80			70			50		
	50	30	50	30	50	30	50	30	50
RW	50	30	50	30	50	30	50	30	50
0	53	53	52	52	50	50			
1	47	46	46	45	45	42			
2	41	40	40	39	40	38			
3	38	34	36	34	35	33			
4	34	29	33	29	32	28			
5	29	27	29	26	28	26			
6	27	23	27	23	26	23			
7	25	20	25	20	23	20			
8	23	19	23	19	22	19			
9	20	17	20	17	20	17			
10	19	16	19	16	19	16			

OM82H32PLTFLR-CSFF Photometric Data

Decorative Lens with Floating Luminous Ring

Report Number: 21440
 Lamp: (2) CFM32W
 Total Lumens: 4800
 Fixture Efficiency: = 52.1%
 IES File: F21440.IES
 S/MH Ratio = 1.1, 1.6
 Beam Angle: 102.19

LIGHTING PERFORMANCE DATA		
CEILING HEIGHT* (FT.)	INITIAL FOOTCANDLES	BEAM DIAMETER (FT.-IN.)
8	34.1	13-8
10	18.3	18-7
12	11.4	23-7
14	7.8	28-6
16	5.7	33-5

DISTRIBUTION CURVE

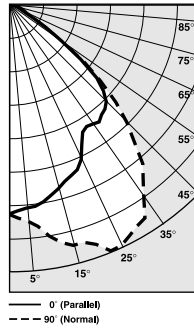

DEGREES	CANDELA		FOOT-LAMBERTS
	AT 0°	AT 90°	
90	10	10	
85	12	14	1342
75	34	42	1321
65	69	89	1682
55	318	302	4864
45	678	820	9533
35	720	1157	
25	843	1309	
15	940	1227	
5	1006	1070	
0	1032	1032	

COEFFICIENTS OF UTILIZATION ZONAL CAVITY METHOD

Effective Floor Cavity Reflectance 0.20

RC	80			70			50		
	50	30	50	30	50	30	50	30	50
RW	50	30	50	30	50	30	50	30	50
0	61	61	60	60	57	57			
1	56	54	55	53	53	51			
2	50	46	48	46	47	45			
3	45	41	44	40	42	40			
4	40	36	40	35	39	35			
5	36	33	35	32	34	32			
6	33	28	33	28	32	28			
7	30	26	29	26	28	26			
8	28	23	28	23	27	23			
9	26	22	25	22	25	20			
10	23	20	23	20	23	20			

OM82H26QPLFLD-CSFF Photometric Data

Decorative Lens with Floating Luminous Disk

Report Number: 21441-1
 Lamp: (2) CFQ26W
 Total Lumens: 3600
 Fixture Efficiency: = 53.3%
 IES File: F214411.IES
 S/MH Ratio = 1.3, 1.5
 Beam Angle: 103.25

LIGHTING PERFORMANCE DATA		
CEILING HEIGHT* (FT.)	INITIAL FOOTCANDLES	BEAM DIAMETER (FT.-IN.)
8	23.7	13-11
10	12.7	18-11
12	7.9	23-12
14	5.4	29-1
16	3.9	34-1

DISTRIBUTION CURVE

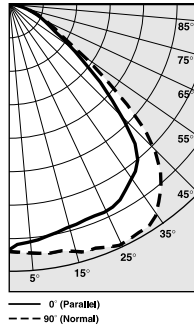

DEGREES	CANDELA		FOOT-LAMBERTS
	AT 0°	AT 90°	
90	9	10	
85	19	19	1962
75	62	65	2208
65	123	134	2737
55	241	292	4182
45	481	608	6930
35	624	750	
25	666	771	
15	671	741	
5	693	723	
0	716	716	

COEFFICIENTS OF UTILIZATION ZONAL CAVITY METHOD

Effective Floor Cavity Reflectance 0.20

RC	80			70			50		
	50	30	50	30	50	30	50	30	50
RW	50	30	50	30	50	30	50	30	50
0	63	63	61	61	58	58			
1	56	55	55	54	53	52			
2	50	46	48	46	46	45			
3	45	40	44	40	41	39			
4	40	35	39	34	38	34			
5	35	32	34	30	34	30			
6	33	28	32	28	30	27			
7	29	25	28	25	28	25			
8	27	23	27	23	26	22			
9	25	20	25	20	23	20			
10	23	19	23	19	22	19			

OM82H26QPLFLR-CSFF Photometric Data

Decorative Lens with Floating Luminous Ring

Report Number: 21442-1
 Lamp: (2) CFQ26W
 Total Lumens: 3600
 Fixture Efficiency: = 62.8%
 IES File: F214421.IES
 S/MH Ratio = 1.1, 1.6
 Beam Angle: 100.74

LIGHTING PERFORMANCE DATA		
CEILING HEIGHT* (FT.)	INITIAL FOOTCANDLES	BEAM DIAMETER (FT.-IN.)
8	32.4	13-3
10	17.4	18-1
12	10.9	22-11
14	7.4	27-9
16	5.4	32-7

DISTRIBUTION CURVE

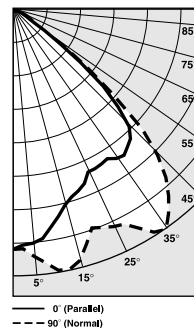

DEGREES	CANDELA		FOOT-LAMBERTS
	AT 0°	AT 90°	
90	8	7	
85	11	13	1239
75	32	35	1165
65	66	75	1501
55	229	256	3805
45	676	840	9648
35	742	1097	
25	732	979	
15	828	1063	
5	959	1013	
0	981	981	

COEFFICIENTS OF UTILIZATION ZONAL CAVITY METHOD

Effective Floor Cavity Reflectance 0.20

RC	80			70			50		
	50	30	50	30	50	30	50	30	50
RW	50	30 <td>50</td> <td>30</td> <td>50</td> <td>30</td> <td>50</td> <td>30</td> <td>50</td>	50	30	50	30	50	30	50
0	75	75	72	72	69	69			
1	68	65	66	64	64	61			
2	60	56	59	56	56	55			
3	55	50	54	50	52	47			
4	48	44	47	44	46	42			
5	44	40	44	39	42	39			
6	40	34	40	34	39	34			
7	36	32	35	32	34	30			
8	34	28	33	28	33	28			
9	30	26	30	26	29	26			
10	28	23	28	23	28	23			

*Readings at working plane, 2'6" above floor. Beam Angle and Diameter Cutoff at 50% of max. Candlpower Coefficients used at effective reflectances of: 70% Ceiling, 50% Walls, 20% Floor
 Additional photometric test files are available @ omegalighting.com

To convert values for optional reflector colors, multiply by:
 Gold .90 Bronze .82 Pewter .87