

OM439PAR20MHRADJ40

4" Recessed Adjustable Downlight

CAT. NO:

TYPE:

PROJECT:

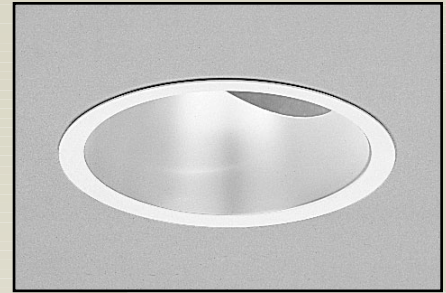

PRODUCT INFORMATION

Applications

Recessed 40° adjustable downlight well suited for general or accent lighting in sloped ceiling applications, auditoriums, schools, churches, restaurants, hotels and offices. Full horizontal rotation makes this fixture ideal for highlighting store displays, sculpture, or vertical surfaces. Low brightness Paracone matches all other 4" aperture downlights from Omega.

Specifications

- Mounting pan** - Precision die-formed 20 gauge galvanized bonderized steel mounting pan. Matte black finish
- Housing** - 22 gauge C.R.S. matte black steel housing removable for access to junction box. Adjustable locking yoke allows full 365° horizontal rotation and 45° vertical tilt for complete aiming flexibility. Lockable slotted rotational ring and yoke provided with nylon bearing surface for smooth gliding and adjustment.
- Ballast** - Totally enclosed, High Power Factor, with <10% THD electronic ballast with internal ignitor, thermally protected. Ballast requires a minimum starting temperature of -30°F. Ballast is either 120V, 60HZ or 277V 60HZ with a sound rating of "A" for indoor applications. Ballast has a "turn-off" function for increased reliability and safety. Total wattage including ballast is 44W for 120V and 46W for 277V.
- Installation** - Mounting pan has pre-installed universal mounting brackets with vertical adjustment. Ballast, junction box and mounting brackets are accessible from below ceiling. Housing is accessible from above ceiling through removable top cover. Allow 2" above unit for servicing from below. For 30" C-channel hanger pair, specify Q1030 accessory, ordered separately. For 27" flat bar hanger pair, specify FB accessory, ordered separately
- Reflector** - Precision spun .050 aluminum one piece reflector, self flanged with clear specular Alzak finish, angle cut at 45° for maximum aiming flexibility. Standard flat flange is painted white. Optional polished flange with matching finish available, add FF to catalog number.
- Socket** - Medium base 4 K.V. pulse rated porcelain socket with nickel plated copper screw shell and 200°C wire.
- Junction box** - Extra large 28-cubic inch 14 gauge galvanized steel with snap-on covers. Approved for through wiring with up to 8 #12 AWG conductors.
- Top relamping** - Fixture is suitable for top relamping.
- Thermal protection** - A thermal protection device which meets all U.L. and NEC requirements is standard.
- U.L. Listed** - For use in damp locations and approved for Through Branch Circuit Wiring. I.B.E.W. union made.

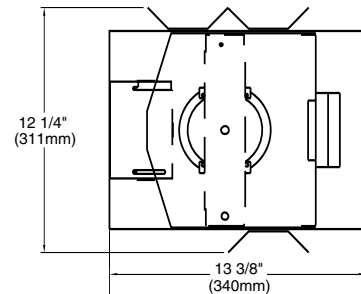
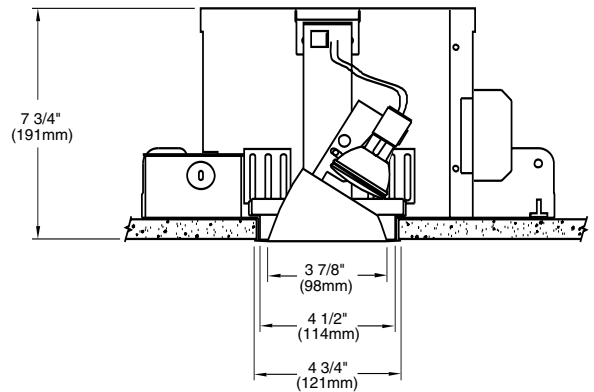

C-Channel not included.

4

CATALOG SYSTEM AND OPTIONS

EXAMPLE OF COMPLETE CATALOG NUMBER: **OM439PAR20MHRADJ40-CS-120EB**

OMEGA Apr.	Lamp (by others)	Lamp Type	Product Family	Reflector Finish*	Frame Options	Supply Voltage
OM4	39 PAR20	MH Metal Halide	RADJ40 Recessed Adjustable (40 degree tilt)	CS Clear Specular CSS Clear Semi-Specular HZ Haze GS Champagne Gold Specular WT Wheat PW Pewter FF Finish Flange (As suffix to color)	FZ Fusing FB Flat Bar Hangers	120EB Electronic 277EB Electronic

*Consult factory for other reflector finishes.



FIVE YEAR
Warranty

OM439PAR20MHRADJ40-CS

Adjustable Downlight with Clear Reflector

Report Number: 20141 Lamp: (1) 39WMH
 Total Lumens: 2000 PAR20 10° Spot
 Fixture Efficiency: = 79.1% IES File: F20141.IES
 Lamp in 40° Tilt Position

DISTRIBUTION CURVE

PHOTOMETRIC DATA

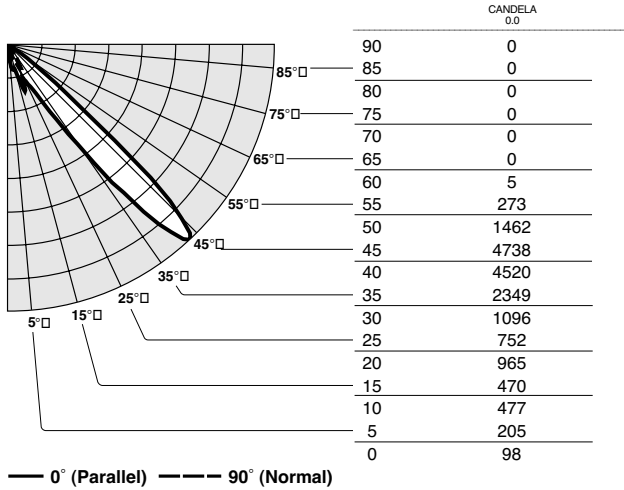

Adjustable Downlight with Clear Reflector

Report Number: 20142 Lamp: (1) 39WMH
 Total Lumens: 2000 PAR20 10° Spot
 Fixture Efficiency: = 71.5% IES File: F20142.IES
 Lamp in 0° Position

DISTRIBUTION CURVE

PHOTOMETRIC DATA

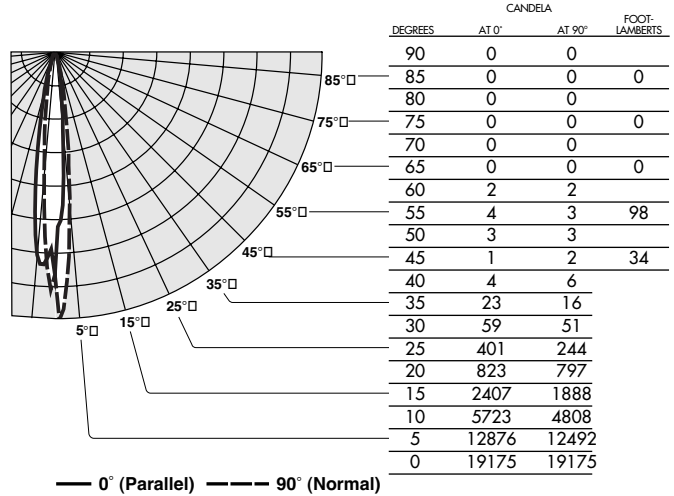

Adjustable Downlight with Clear Reflector

Report Number: 20143 Lamp: (1) 39WMH
 Total Lumens: 2000 PAR20 30° Flood
 Fixture Efficiency: = 92.1% IES File: F20143.IES
 Lamp in 40° Tilt Position

DISTRIBUTION CURVE

PHOTOMETRIC DATA

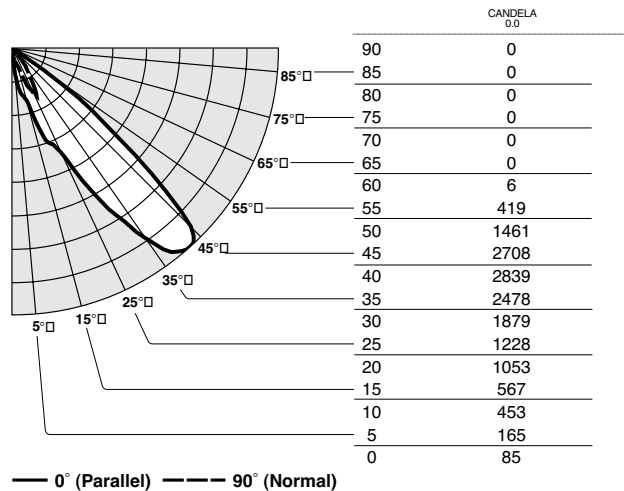

Adjustable Downlight with Clear Reflector

Report Number: 20141 Lamp: (1) 39WMH
 Total Lumens: 2000 PAR20 30° Flood
 Fixture Efficiency: = 79.1% IES File: F20141.IES
 Lamp in 0° Position

DISTRIBUTION CURVE

PHOTOMETRIC DATA

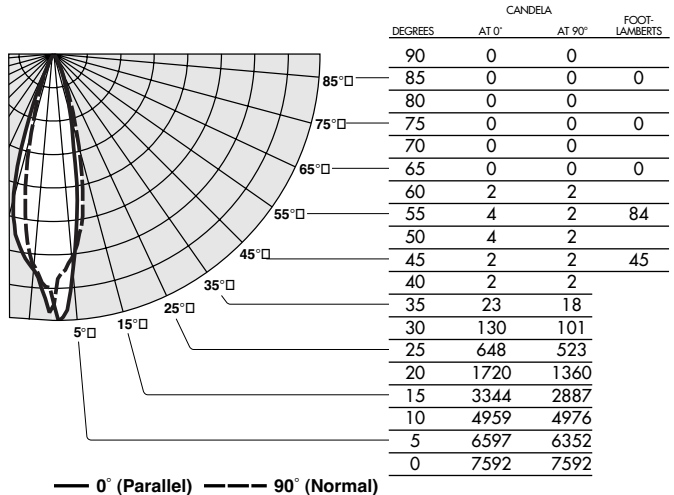

*Readings at working plane, 2'6" above floor. Beam Angle and Diameter Cutoff at 50% of max.
 Candelpower Coefficients used at effective reflectances of: 70% Ceiling, 50% Walls, 20% Floor

To convert values for optional reflector colors, multiply by:
 Gold .90 Bronze .82 Pewter .87

Additional photometric test files are available @ omegalighting.com



OMEGA LIGHTING:
 776 South Green St., Tupelo, MS 38804
 Phone 662.842.7212 FAX 662.841.5501

CANADIAN DIVISION:
 189 Bullock Drive, Markham, Ontario, Canada L3P 1W4
 Phone 905.294.9570 FAX 800.268.0003

4