

# OM8100ED17MHPC SPL

## 8" Splay Lens Cylinder

CAT. NO:

TYPE:  PROJECT:

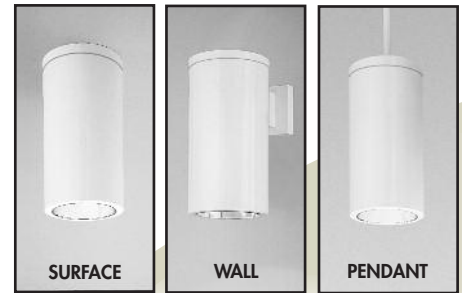

### PRODUCT INFORMATION

#### Applications

Lensed cylinder for use with energy efficient HID lamps. Provides broad uniform light distribution while concealing lamp image and maintaining good visual cutoff. Ideal for areas such as lobbies, corridors, canopies, soffits, restaurants and offices.

#### Specifications

- Housing** - Aluminum cylinder with cast aluminum top and bottom ring on pendant and wall units.
- Installation** - Top plate assembly mounts directly to outlet box. Anchor holes are provided. Socket and ballast are mounted to top plate and are accessible for servicing by removal of screws secured to housing. Junction box with 3/8" IPS stud required.
- Splay Trim** - Spun aluminum regressed splay trim with white powder paint finish. Torsion spring mounting for ease of installation. Flat fresnel and prismatic lens for smooth, even distribution of light. Flat clear tempered lens for enclosed applications.
- Ballast** - Encased and potted, core and coil, high power factor, reactance ballast. Ballast requires a minimum starting temperature of -40°F. Standard ballast is 120/277 dual tap, 60 hertz. For remote operation, voltages other than 120 or 277 or 50 HZ operation, consult factory.
- Socket** - Medium base, 4 k.v. pulse rated porcelain socket with 200° C rated leads.
- Optional Fusing** - Add FZ120 for 120 volt, FZ277 for 277 volt or FZ347 for 347 volt.
- Aligning Canopy** (pendant only) - Die cast aluminum free moving and self aligning outlet box cover. Attaches to 3-1/2" or 4" octagon outlet box (by others). Allows for up to 45° adjustability for use with sloped ceilings or seismic requirements. Add AC2 for two aligning canopies - one mounted to outlet box, and one mounted to fixture.
- U.L. Listed** - For use in damp locations, for wet locations add option "WL". I.B.E.W. union made.

Canadian Specifications may vary from these shown, consult Canadian Division.

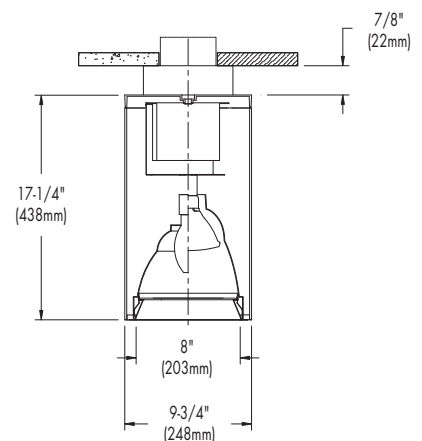
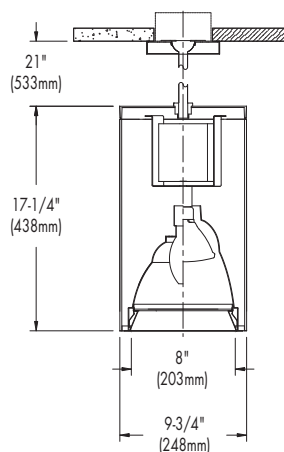
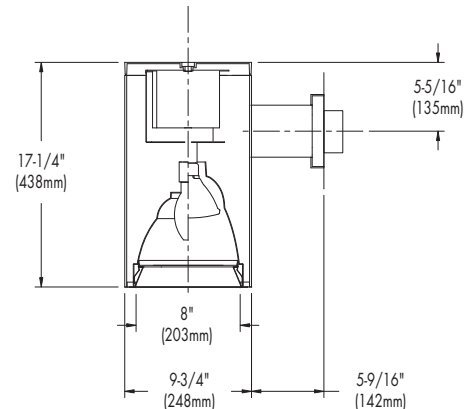

8

### CATALOG SYSTEM AND OPTIONS

EXAMPLE OF COMPLETE CATALOG NUMBER: OM8100ED17MHPC SPL-FL-U

OMEGA Aprt	Lamp (by others)	Lamp Type	Product Family	Reflector Type	Lens (required)	Frame Options	Supply Voltage
OM8	100 ED17 70 ED17 50 ED17 100 PAR38 70 PAR30	MH Metal Halide	SC Surface Cylinder WC Wall Cylinder PC Pendant Cylinder*	SPL Splay Lens (white) CSSPL Clear Semi-Specular BBSPL Black Baffle Splay BKSPL Splay Lens (black)	FL Fresnel Lens PL Prismatic Lens CL Clear Lens	FZ120 Fusing FZ277 Fusing FZ347 Fusing WL Wet Location AC2 2 Aligning Canopies BK Black BZ Bronze ALA Aluminum QR Quartz Restrike	U 120/277 3 347



FIVE YEAR  
Warranty

\*Stem length is 21". Consult factory for other lengths.

Consult factory for photometrics.

8

\*Readings at working plane, 2'6" above floor. Beam Angle and Diameter Cutoff at 50% of max.  
Candlepower Coefficients used at effective reflectances of: 70% Ceiling, 50% Walls, 20% Floor

To convert values for optional reflector colors, multiply by:  
Gold .90      Bronze .82      Pewter .87

Additional photometric test files are available @ [omegalighting.com](http://omegalighting.com)