



application

- The Philips Capri LED Display Luminaire is ideal for use in under/over cabinet, display, ceiling coves, jewelry cases, fine merchandise cases, backlighting signs, and refrigerated case applications. The high-brightness LEDs provide smooth, even illumination without adding heat or UV radiation that can damage or fade merchandise. The array of the LEDs adds sparkle and highlights that will help draw attention to any display.

features

- Low Profile - offers discrete installation within casework or coves.
- Dimming - Hard-wired drivers are dimming capable. See dimming guide.
- Mounting- (2) Easy to install mounting clips come standard with every luminaire. Stainless steel C-clips mount quickly with supplied wood screws, then luminaire simply snaps into C-clips.
- Integral Connectors- provide easy tool-less connection for straight runs of CUCL luminaire. One continuous run must not exceed 8 feet.

construction

- Housing- 0.70" diameter extruded aluminum housing is durable and helps dissipate heat generated by the LED. Extruded ribs allow for mounting clips to easily secure luminaire while providing adjustable aiming.
- LEDs- High brightness, LEDs available in 3000K and 4000K CCT. Provides 70% lumen maintenance at 50,000 hours. Luminous flux is nominally 200 lm per linear foot.
- Optical cover- Durable, clear, polycarbonate cover ensures safe operation of LED components and provides impact resistance.

accessories

- End to End Connectors- Luminaires may be connected end to end. The optional CUCEC Connector is an interconnecting cable that allows for a flexible and continuous row of power when the application does not allow luminaires to be connected directly to one another.

listings & warranty

- U.L. 2108 listed for damp locations.
- Canadian Specifications may vary from these shown, consult Canadian Division.
- 3 year Warranty.



CUCMC Mounting Clips

2 included with every luminaire.

Specifier's Reference

Project
Type
Model No.
Comments

Sample Catalog Number: CUCL05CW

HOUSING

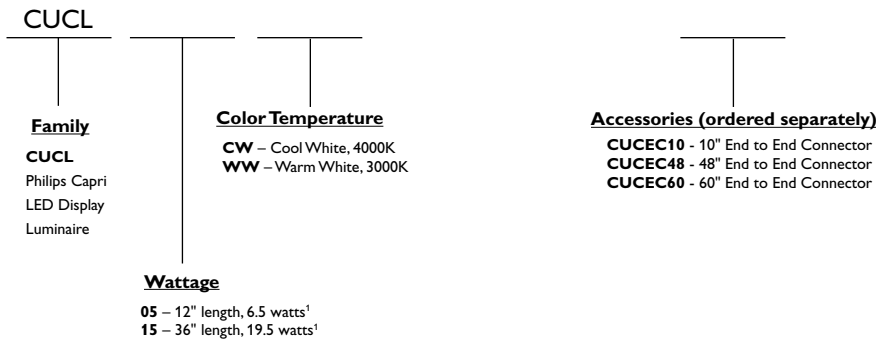

Footnotes

1. Total wattage includes driver.

General Notes

One continuous run of luminaires must not exceed 8 feet. See specification sheet SW3-2 for specification information on drivers and plug-in accessories.

luminaire dimensions

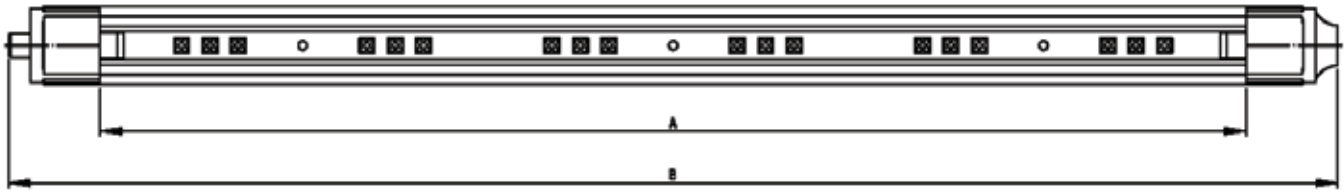

Cat No.	Diameter	Length A	Length B
CUCL05	0.70" (18 mm)	10.36" (263 mm)	12.00" (305 mm)
CUCL15	0.70" (18 mm)	33.64" (854 mm)	35.30" (896 mm)

connector accessories (ordered separately)

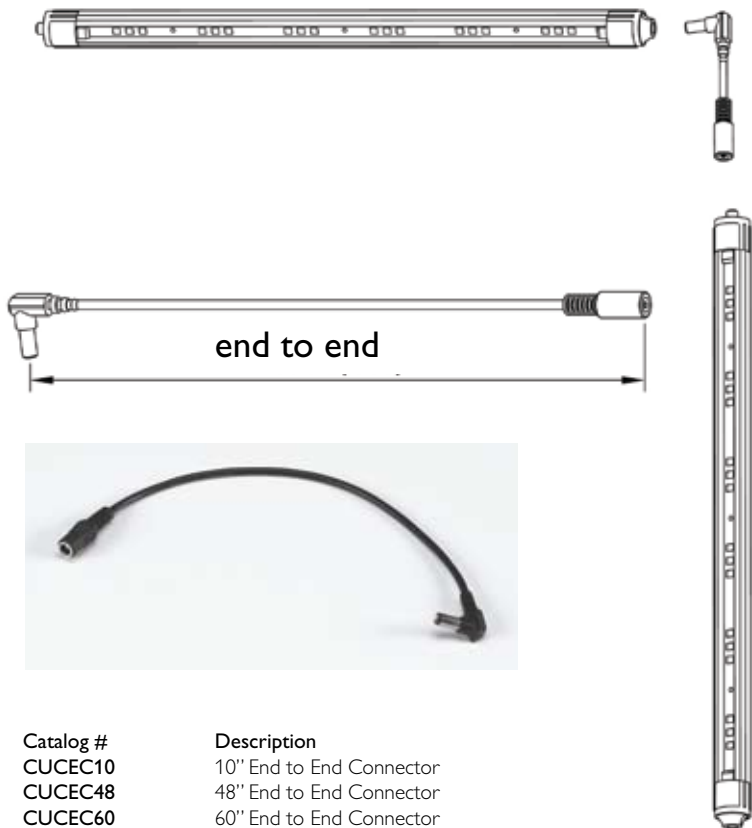

Catalog #	Description
CUCEC10	10' End to End Connector
CUCEC48	48' End to End Connector
CUCEC60	60' End to End Connector

* Note: One continuous run of luminaires must not exceed 8 feet.

power supply accessories (ordered separately)

Note: See specification sheet SW3-2 for specific information on drivers and plug in accessories.

hard-wire accessories

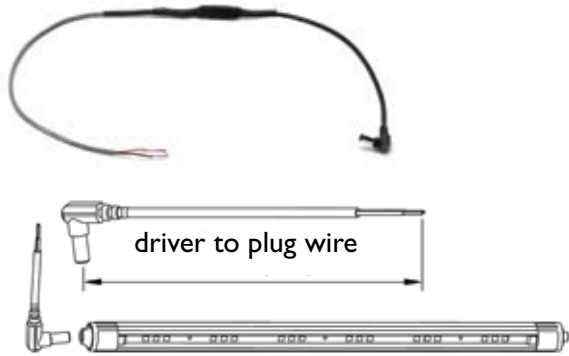

The CLD power supplies are for use in applications requiring higher-wattage. CUCWC plug to wire connector is required to connect power supply to the first luminaire in a run. The CLD power supplies are dimming capable.

Catalog#	Description
CUCWC30	30' Plug to wire connector
CUCWC60	60' Plug to wire connector
CUCWC120	120' Plug to wire connector

Catalog#	Description
CLD20U	LED Remote driver - 20W max capacity
CLD40U	LED Remote driver - 40W max capacity
CLD60U	LED Remote driver - 60W max capacity

plug-in accessories



The CLPD power supply offers the convenience of a plug-in power supply. Power supply is equipped with male connector and is ready to plug into luminaire.

The CLPD power supply is non-dimmable.

Catalog#	Description
CLPD25	LED Power Supply with Plug- 25 watt capacity



©2011 Philips Capri
 All rights reserved.
 776 South Green Street • Tupelo, MS 38804
 p. 800.234.1890 • f. 662.841.5501
 www.caprilighting.com
 Canadian Division
 189 Bullock Drive • Markham, Ontario L3P 1W4
 p. 905.294.9570 • f. 905.294.9811

Contact Factory for Additional Configurations.
 Specifications are subject to change without notice.



Some luminaires use fluorescent or high intensity discharge (HID) lamps that contain small amounts of mercury. Such lamps are labeled, "Contain Mercury" and/or the symbol "Hg". Lamps that contain mercury must be disposed of in accordance with local requirements. Information regarding lamp recycling and disposal can be found at www.lamprecycle.org