

CT6538, 6510 atTRACTION

Line Voltage 120V

Catalog Number: _____

Type _____

Project: _____



CT6538

shown with PAR30L

Description

Forward slant profile contours smoothly into fluted tail section for a soft new shape. For use in showrooms, retail, and residential applications. PAR lamps are easily loaded from the front of the fixture.

Features

- Full range of adjustment.
- Easy maintenance.
- UL listed.
- Array of accessories adapts fixture into various project designs.
- Integral switch on track plug housing permits interruption of power for routine lamp maintenance.
- 93 degree vertical tilt.
- Operates on 120 volt line voltage.

Lamps Available:

- 90W to 250W PAR38
- 50W to 75W PAR30
- 50W PAR20

CATALOG SYSTEM AND OPTIONS

SAMPLE CATALOG NUMBER: CT6538W

Track Head Finishes

CT6538 50W PAR20 75W PAR30 90W PAR38	W White BK Black SL Silver
CT6510 GU10	

Footnotes:

1. For use with PAR20
2. For use with PAR30
3. For use with PAR30L
4. For use with PAR38
5. Color Filters - See back of page for breakdown.

General Notes:

Available lamps listed under lamp head. Lamps not included.

Accessories (order separately)

Bezel	Cone	Gimbal	Mesh	Collar	Gimbal Rings	Accessory Finishes
CZ25¹ CZ35² CZ35L³ CZ38⁴ CZ10	CC25¹ CC35² CC35L³ CC38⁴ CC10	CG25¹ CG35² CG35L³ CG38⁴ CG10	CM25¹ CM35² CM35L³ CM38⁴ CM10	CO25	CA225¹ CA235²⁻³ CA238⁴	W White BK Black SL Silver

SPECIFICATIONS

1. **Fixture Head** - Made of die-cast aluminum which aids in the dissipation of heat. Sleek forward slant profile transitions smoothly into fluted tail section. For use in showrooms, retail, commercial and residential applications.
2. **Socket** - Porcelain, medium base with nickel plated copper screw shell.
3. **Finishes** - Choice of finishes in W (white), BK (black) or SL(silver).

Accessories

Bezel - Tapered lamp shade is designed to contour the PAR shaped ceramic metal halide lamps providing a clean finished look. Attaches to base unit (CT6538) by two key hole slots.

Cone - Conical shaped shade designed to conceal the PAR shaped ceramic metal halide lamps. Attaches to base unit (CT6538) by two key hole slots.

Gimbal Ring - Gimbal ring provides a traditional open lamp decorative piece to PAR shaped ceramic metal halide lamps. Attaches to base unit (CT6538) by two key hole slots.

Mesh - Wire mesh lamp shade is designed to fit PAR shaped ceramic metal halide lamps providing innovative look to fixture. Attaches to base unit (CT6538) by two key hole slots.

Collar - Color matched collar aids to conceal neck of lamp. Cannot be used with other accessories.

SHROUD CHART

	Bezel	Cone	Gimbal	Mesh	Collar
GU10	CZ10	CC10	CG10	CM10	CO25
PAR20	CZ25	CC25	CG25	CM25	CO25
PAR30	CZ35	CC35	CG35	CM35	CO25
PAR30L	CZ35L	CC35L	CG35L	CM35L	CO25
PAR38	CZ38	CC38	CG38	CM38	CO25

ACCESSORY CHART

	PAR20	PAR30	PAR30L	PAR38
Gimbal Ring	CA225*	CA235*	CA235*	CA238*
Louver/Filter Holder	CH25	CH35	CH35	CH38
Louver	CL25	CL35	CL35	CL38
Barndoor	CB25	CB35	CB35	CB38
Filter Series	CF43-CF46	CF13-CF17	CF13-CF17	CF22-CF27

* Required when using any accessory.

DIMENSIONS

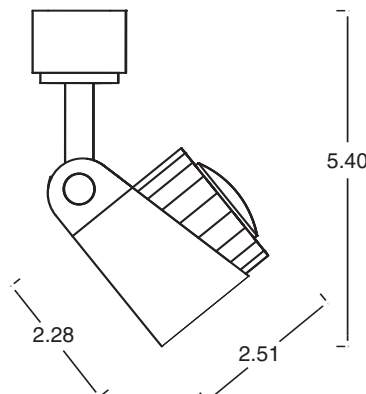

REV. 09/05

CT6538

LAMP DATA

LEGEND

- D** Distance from wall to track in feet.
- H** Distance from ceiling to center of object in feet.
- S** Spacing between fixtures for uniform (2:1) illumination.
- FC** Footcandle level at center of beam. Footcandle values have been cosine corrected.
- L** Effective visual beam length in feet.
- W** Effective visual beam width in feet.

Note: Beamspreads are measured to 50% MCP.

PAR20 NARROW SPOT 

50W, 120V NARROW SPOT
RATED LIFE: 2000 hours BEAM SPREAD: 10°

	VERTICAL					D = DISTANCE FROM WALL (FEET)														
	0'		3'		4'		5'		6'		3'		4'		5'		6'			
H	S	FC	L	W	FC	L	W	FC	L	W	FC	L	W	FC	L	W	FC	L	W	
4	1.1	377	0.7	0.7	145	1.5	0.9	133	1.4	1.0	114	1.5	1.1	96	1.5	1.3				
6	1.5	167	1.0	1.0	61	2.6	1.2	65	2.3	1.3	64	2.1	1.4	59	2.1	1.5				
8	2.0	94	1.4	1.4	30	4.3	1.5	34	3.5	1.5	36	3.2	1.7	36	2.9	1.7				
10	2.5	60	1.7	1.7	15	7.6	1.9	19	5.2	1.9	22	4.4	1.9	23	4.0	2.0				

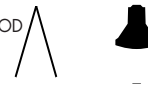
PAR20 NARROW FLOOD 

50W, 120V NARROW FLOOD
RATED LIFE: 2000 hours BEAM SPREAD: 26°

	VERTICAL					D = DISTANCE FROM WALL (FEET)														
	0'		2'		3'		4'		5'		2'		3'		4'		5'			
H	S	FC	L	W	FC	L	W	FC	L	W	FC	L	W	FC	L	W	FC	L	W	
3	2.0	206	1.4	1.4	80	3.3	1.7	73	2.9	2.0	59	3.0	2.3	47	3.2	2.7				
4	2.6	116	1.8	1.8	42	5.6	2.0	45	4.2	2.3	41	3.9	2.6	35	4.0	3.0				
5	3.4	74	2.3	2.3	24	9.8	2.5	28	6.1	2.7	28	5.1	2.9	26	4.9	3.3				
6	4.0	51	2.8	2.8	14	11.6	3.0	19	8.5	3.1	20	6.7	3.3	19	6.0	3.6				

PAR30 NARROW FLOOD 

75W, 120V NARROW FLOOD
RATED LIFE: 2000 hours BEAM SPREAD: 27°

	VERTICAL					D = DISTANCE FROM WALL (FEET)														
	0'		2'		3'		4'		5'		2'		3'		4'		5'			
H	S	FC	L	W	FC	L	W	FC	L	W	FC	L	W	FC	L	W	FC	L	W	
3	1.8	395	1.4	1.4	153	3.5	1.7	140	3.1	2.0	113	3.1	2.4	90	3.4	2.8				
4	2.4	222	1.9	1.9	81	6.0	2.1	86	4.4	2.4	78	4.1	2.7	67	4.1	3.1				
5	3.0	142	2.4	2.4	46	9.0	2.6	54	6.5	2.8	55	5.3	3.1	50	5.1	3.4				
6	3.6	99	2.9	2.9	27	12.8	3.1	36	9.0	3.2	38	7.0	3.4	37	6.3	3.7				

PAR30 FLOOD 

75W, 120V FLOOD
RATED LIFE: 2000 hours BEAM SPREAD: 36°

	VERTICAL					D = DISTANCE FROM WALL (FEET)														
	0'		2'		3'		4'		5'		2'		3'		4'		5'			
H	S	FC	L	W	FC	L	W	FC	L	W	FC	L	W	FC	L	W	FC	L	W	
2	1.6	650	1.3	1.3	230	2.9	1.8	166	3.0	2.4	116	3.4	3.6	83	3.8	3.5				
3	2.3	289	1.9	1.9	112	5.4	2.3	102	4.4	2.8	83	4.3	4.1	66	4.6	3.8				
4	3.1	163	2.6	2.6	59	8.2	2.9	63	6.6	3.2	57	5.8	4.6	49	5.8	4.2				
5	3.9	104	3.2	3.2	34	10.6	6.9	39	10.4	3.8	40	7.8	5.2	37	7.3	4.6				

PAR38 SPOT 

90W, 120V SPOT
RATED LIFE: 2000 hours BEAM SPREAD: 10°

	VERTICAL					D = DISTANCE FROM WALL (FEET)														
	0'		3'		4'		5'		6'		3'		4'		5'		6'			
H	S	FC	L	W	FC	L	W	FC	L	W	FC	L	W	FC	L	W	FC	L	W	
4	1.0	1161	0.7	0.7	447	1.5	0.9	411	1.4	1.0	352	1.5	1.1	296	1.5	1.3				
6	1.4	516	1.0	1.0	187	2.6	1.2	200	2.3	1.3	196	2.1	1.4	182	2.1	1.5				
8	2.0	290	1.4	1.4	91	4.3	1.5	105	3.5	1.5	111	3.2	1.7	112	2.9	1.7				
10	2.5	186	1.7	1.7	47	7.6	1.9	60	5.2	1.9	67	4.4	1.9	70	4.0	2.0				

PAR38 FLOOD 

90W, 120V FLOOD
RATED LIFE: 2000 hours BEAM SPREAD: 30°

	VERTICAL					D = DISTANCE FROM WALL (FEET)														
	0'		2'		3'		4'		5'		2'		3'		4'		5'			
H	S	FC	L	W	FC	L	W	FC	L	W	FC	L	W	FC	L	W	FC	L	W	
3	1.9	472	1.6	1.6	183	4.1	1.9	167	3.5	2.3	136	3.5	2.7	107	4.2	3.1				
4	2.5	266	2.1	2.1	96	7.2	2.4	102	5.1	2.7	94	4.6	3.0	81	4.7	3.4				
5	3.2	170	2.7	2.7	55	10.0	2.9	64	7.6	3.1	65	6.1	3.4	60	5.8	3.8				
6	3.8	118	3.2	3.2	33	12.0	3.5	43	10.8	3.5	46	8.1	3.8	45	7.2	4.2				

PAR38 SPOT 

Q250W, 120V SPOT
RATED LIFE: 6000 hours BEAM SPREAD: 14°

	VERTICAL					D = DISTANCE FROM WALL (FEET)														
	0'		3'		4'		5'		6'		3'		4'		5'		6'			
H	S	FC	L	W	FC	L	W	FC	L	W	FC	L	W	FC	L	W	FC	L	W	
6	1.6	1295	1.5	1.5	470	3.8	1.6	501	3.2	1.8	491	3.0	1.9	458	3.0	2.1				
8	2.1	729	2.0	2.0	229	6.4	2.1	265	5.1	2.2	278	4.5	2.3	281	4.2	2.4				
10	2.6	466	2.5	2.5	118	11.9	2.7	151	7.7	2.6	169	6.3	2.7	177	5.8	2.9				
12	3.1	324	2.9	2.9	74	16.6	3.0	95	10.6	3.0	108	8.8	3.1	118	7.6	3.2				

PAR38 FLOOD 

Q250W, 120V FLOOD
RATED LIFE: 6000 hours BEAM SPREAD: 27°

	VERTICAL					D = DISTANCE FROM WALL (FEET)														
	0'		3'		4'		5'		6'		3'		4'		5'		6'			
H	S	FC	L	W	FC	L	W	FC	L	W	FC	L	W	FC	L	W	FC	L	W	
4	2.7	640	1.9	1.9	246	4.4	2.4	226	4.1	2.7	194	4.1	3.1	163	4.3	3.5				
6	4.0	284	2.9	2.9	103	9.0	3.2	110	7.0	3.4	108	6.3	3.7	101	6.1	4.1				
8	5.3	160	3.8	3.8	50	17.2	4.0	58	12.0	4.2	61	10.0	4.5	62	8.9	4.8				
10	6.6	102	4.8	4.8	26	19.0	5.2	33	18.0	5.1	37	15.0	5.3	39	12.9	5.6				

FILTER ORDERING CHART Requires gimbal ring accessory (CA225, CA235, CA238) and louver filter holder (CH25, CH35, CH38).

Catalog #	Diameter	Description	Catalog #	Diameter	Description
PAR30			CF24	4-1/2"	Red Filter
CF13	3 5/8"	Blue Filter	CF25	4-1/2"	Green Filter
CF14	3 5/8"	Red Filter	CF26	4-1/2"	Amber Filter
CF15	3 5/8"	Green Filter	CF27	4-1/2"	UV Filter
CF16	3 5/8"	Amber Filter	PAR20		
CF17	3 5/8"	UV Filter	CF40	2 3/16"	Spread Filter
PAR38			CF43	2 3/16"	Blue Filter
CF22	4-1/2"	Spread Filter	CF44	2 3/16"	Red Filter
CF23	4-1/2"	Blue Filter	CF45	2 3/16"	Green Filter
			CF46	2 3/16"	Amber Filter

Capri Lighting reserves the right to make changes without notice. ©2004

TR1-22

CAPRI LIGHTING:
776 South Green St., Tupelo, MS 38804
Phone 662.842.7212 FAX 662.841.5501
www.caprilighting.com

CANADIAN DIVISION:
189 Bullock Drive, Markham, Ontario, Canada L3P 1W4
Phone 905.294.9570 FAX 800.268.0003

capri
LIGHTING