

JOB NAME _____

TYPE _____

V2 SERIES SPECIFICATION VAPORLUME - 8'

1, 2 or 3 Lamp

T8 or T12

Slimline T8 or T12

High Output T8(380mA) or T12(800mA)

NSF Certified for Non-Food Zone Installations.



APPLICATION

- Acceptable for outdoor as well as indoor installations.
- Can be surface (wall/ceiling) or suspended mounted unless otherwise specified.
- **Wet Location** - Areas of high humidity, water vapor, rain, incidental water spray, or other non-corrosive or non-flammable liquid.

CONSTRUCTION/FINISH

- Non-conductive, non-corrosive housing.
- Smooth exterior surface for easy cleaning.
- Molded fiberglass reinforced polyester body.
- High impact DR acrylic or polycarbonate molded lens.
- Continuous closed cell, foam in-place gasket.
- Tamper resistant latches are standard.
- Lighting channel painted after fabrication with polyester powder coating.

ELECTRICAL

- Class P, HPF, CBM certified ballasts.
- Electronic ballasts are standard on high ambient and high output (86HO, 96HO) models.
- Self-contained fluorescent emergency ballasts available: Wet location only, use DEB-7W or DEB-5W
- UL/cUL listed.
- Wet Location UL 1570/cUL C22.2 No. 9.
- Day-Brite's standard fixtures for high output T8 (380mA) and T12 (800mA) include ballasts rated for -20° F starting temperature.

ACCESSORIES

- **TBK** – Stainless Steel Top Bracket Kit (pair of brackets plus hardware)
- **EBK** – Stainless Steel End Bracket Kit (pair of brackets plus hardware)
- **WBK** – Wraparound stainless steel brackets (pair) for surface or chain mounting.
- **FKR-126** – Chain Hanger Set (requires TBK)
- **T15TPTOOL** – TORX® T15 Pin-in-head Tamperproof Screwdriver

CATALOG NUMBER (example: V2WAE296-120-TR)

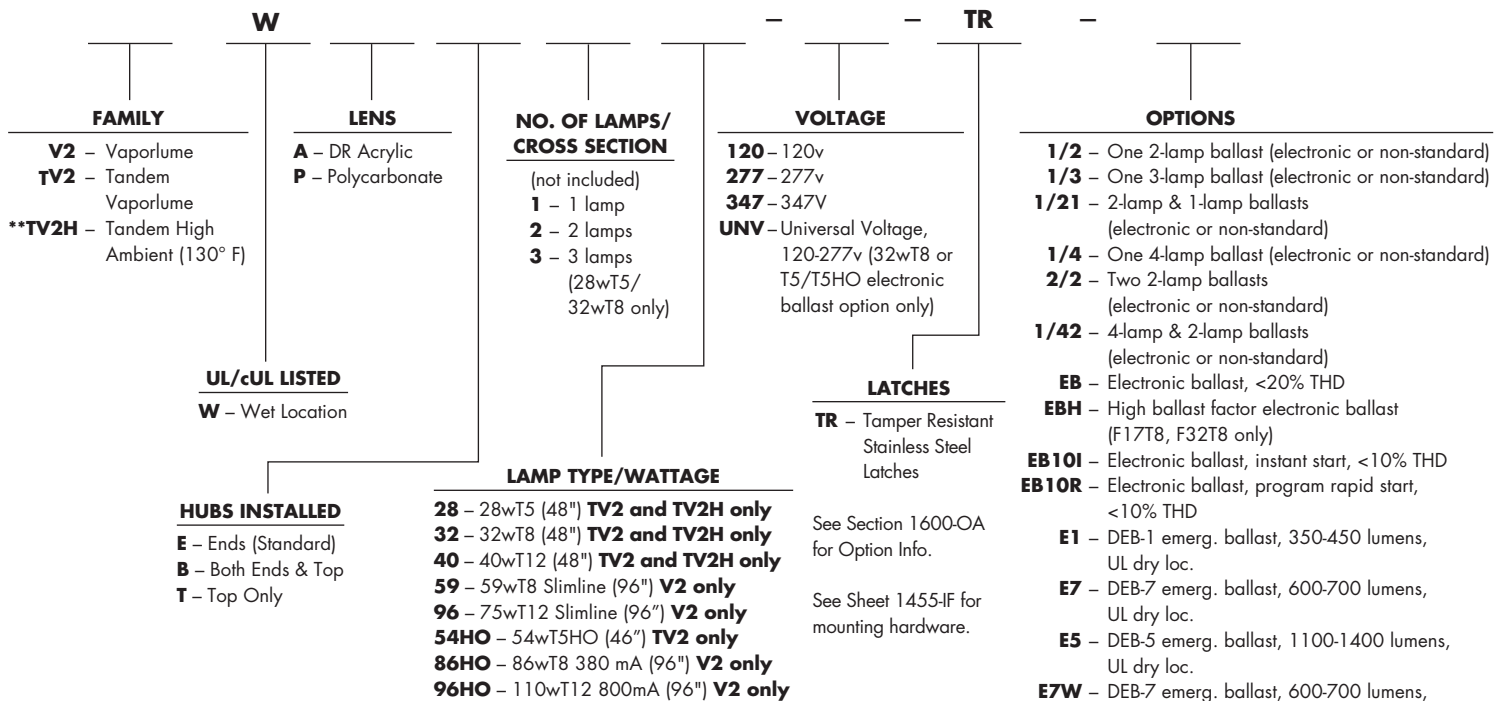

- With generic Electronic Ballasts (Brand selected by Day-Brite)
 Suffix Catalog # with- **Ballast Quantity** | - / - | **EB** **Lamps Per Ballast.**

Example: -1/2-EB = One 2 Lamp Electronic Ballast.

Example: -1/4-EB = One 4 Lamp Electronic Ballast.

** 28, 32 or 40 lamps only

V14027

V2 SERIES SPECIFICATION VAPORLUME - 8'



Vandal Resistant
by Day-Brite Lighting

DIMENSIONS

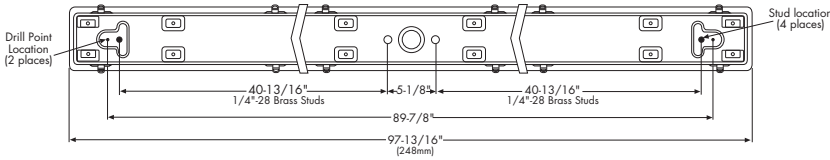

TBK - Top Mounting Bracket

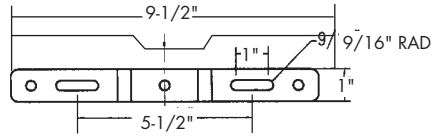

EBK - End Mounting Bracket



EBK - End Mounting Bracket

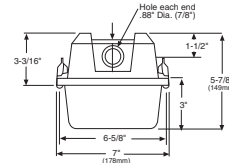

SHALLOW LENS VERSION (STANDARD)

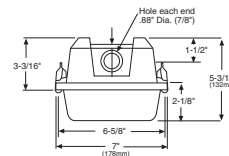

DEEP LENS VERSION FOR HIGH AMBIENT, OR WHEN 800mA LAMPS ARE OPERATED ON MAGNETIC BALLASTS.

PHOTOMETRIC DATA

CATALOG # V2WAE259-120-1/2-EB LAMPS = F96T8
TEST #LSC7929 S/MH=1.5 BALLAST = ELECTRONIC

INPUT WATTS = 102
BALLAST FACTOR = .85

LER = FL-74

COMPARATIVE YEARLY LIGHTING ENERGY COST PER 1000 LUMENS = \$3.24 BASED ON 3000 HRS. AND \$.08 PER KWH.

FIXTURE EFFICIENCY = 76.6%

CANDLEPOWER				
Angle	End	45	Cross	
0	2033	2033	2033	
5	2054	2045	2017	
15	1977	2055	2075	
25	1839	1992	2077	
35	1629	1895	2033	
45	1362	1715	1911	
55	995	1465	1674	
65	624	1176	1495	
75	337	962	1270	
85	114	630	862	
95	54	406	620	
105	30	231	402	
115	24	114	171	
125	19	52	40	
135	18	32	22	
145	7	18	3	
155	11	25	0	
165	26	8	2	
175	25	20	4	

MAINTAINED ILLUMINATION TABLE- Square Feet/Fixture*

<ul style="list-style-type: none"> 80-50-20 Reflectances (Ceiling-Wall-Floor) LLF = 0.74 5800 Lumens/Lamp very clean Room width divided by room height = 5 or more, 2 or 1 						
Fixture Size & # of Lamps	Room Width Room Height =	Approx. Area (sq. ft.) per Fixture				
		10 ft-c	30 ft-c	50 ft-c	70 ft-c	100 ft-c
2-lamp 59w	5 2 1	- - -	- 137 98	126 82 59	90 59 42	63 41 -

*Observe Fixture S/MH Requirements for Specific Applications

Average LUMINANCE CD/SQ.M with 5800 Lumen Lamps				
ANGLE	END	45°	CROSS	
45	5585	5601	5807	
55	4986	5390	5612	
65	4182	5133	5785	
75	3574	5361	6028	
85	3122	5067	5506	

TYPICAL V.C.P.'s				
Room Size	Mounting Height		Crosswise	
	Lengthwise	10	8.5	10
30x30	34	40	26	31
40x40	31	35	24	27
60x30	35	39	30	35
60x60	29	31	21	24
100x100	28	29	21	22

COEFFICIENT OF UTILIZATION

pfc pcc pw RCR	20	70		50	
	70 50 30	70 50 30	50 30	50 30	30
0	89	89	86	86	81
1	79	75	70	76	68
2	70	64	57	68	61
3	64	55	47	61	54
4	58	48	40	56	46
5	54	42	35	52	41
6	48	39	30	46	36
7	46	34	28	44	34
8	41	32	25	40	30
9	40	28	22	38	28
10	36	27	20	35	26

LIGHT DISTRIBUTION

DEGREES	LUMENS	% LAMP	% FIXTURE
0-30	1684	14.5	19.0
0-40	2854	24.6	32.1
0-60	5402	46.6	60.8
0-90	8066	69.5	90.8
90-180	815	7.0	9.2
0-180	8881	76.6	100.0

LLF = .74 LLF = LIGHT LOSS FACTOR LLF = LDD X LLD X BF LDD = VERY CLEAN 0.94 CLEAN 0.90
LDO = 0.88 @ 40% RATED LAMP LIFE BF = 0.85 ELECTRONIC BALLAST & 59wT8 LAMP (RELAMP AT 70% LAMP LIFE)

PHOTOMETRIC DATA

CATALOG # V2WAE286HO-120-1/2-EB LAMPS = F86T8HO
TEST #LSC7930 S/MH=1.5 BALLAST = ELECTRONIC

INPUT WATTS = 145
BALLAST FACTOR = .88

LER = FL-70

COMPARATIVE YEARLY LIGHTING ENERGY COST PER 1000 LUMENS = \$3.43 BASED ON 3000 HRS. AND \$.08 PER KWH.

FIXTURE EFFICIENCY = 72.6%

CANDLEPOWER				
Angle	End	45	Cross	
0	2671	2671	2671	
5	2683	2681	2660	
15	2606	2682	2705	
25	2420	2633	2724	
35	2130	2484	2627	
45	1742	2230	2408	
55	1276	1876	2123	
65	797	1537	1907	
75	414	1246	1607	
85	132	836	1113	
95	73	562	806	
105	60	338	542	
115	44	154	275	
125	28	84	78	
135	36	20	36	
145	28	29	7	
155	33	9	1	
165	38	31	3	
175	30	15	8	

MAINTAINED ILLUMINATION TABLE- Square Feet/Fixture*

<ul style="list-style-type: none"> 80-50-20 Reflectances (Ceiling-Wall-Floor) LLF = 0.74 8000 Lumens/Lamp Clean Room width divided by room height = 5 or more, 2 or 1 						
Fixture Size & # of Lamps	Room Width Room Height =	Approx. Area (sq. ft.) per Fixture				
		10 ft-c	30 ft-c	50 ft-c	70 ft-c	100 ft-c
2-lamp 86w	5 2 1	- - -	- 131	110 79	78 56	84 39

*Observe Fixture S/MH Requirements for Specific Applications

Average LUMINANCE CD/SQ.M with 8000 Lumen Lamps				
ANGLE	END	45°	CROSS	
45	7143	7282	7317	
55	6394	6903	7117	
65	5342	6709	7380	
75	4391	6944	7627	
85	3614	6724	7109	

TYPICAL V.C.P.'s				
Room Size	Mounting Height		Crosswise	
	Lengthwise	10	8.5	10
30x30	28	33	22	26
40x40	25	28	19	22
60x30	29	32	25	29
60x60	24	25	17	19
100x100	23	23	17	18

COEFFICIENT OF UTILIZATION

pfc pcc pw RCR	20	70		50	
	70 50 30	70 50 30	50 30	50 30	30
0	84	84	84	81	81
1	75	70	67	71	68
2	68	60	55	65	58
3	60	53	46	58	51
4	56	46	39	53	45
5	51	40	34	48	40
6	46	36	29	45	35
7	42	33	26	41	32
8	40	29	23	39	28
9	38	27	20	35	27
10	34	25	19	34	25

LIGHT DISTRIBUTION

DEGREES	LUMENS	% LAMP	% FIXTURE
0-30	2208	13.8	19.0
0-40	3732	23.3	32.1
0-60	7009	43.8	60.3
0-90	10465	65.4	90.1
90-180	1153	7.2	9.9
0-180	11618	72.6	100.0

LLF = .74 LLF = LIGHT LOSS FACTOR LLF = LDD X LLD X BF LDD = VERY CLEAN 0.94 CLEAN 0.90
LDO = 0.88 @ 40% RATED LAMP LIFE BF = 0.88 ELECTRONIC BALLAST & 86wT8HO LAMP (RELAMP AT 70% LAMP LIFE)